



**BILL HOLLINGSHEAD**

*TRG The Realty Group*

Cell: 778-836-3915

Office: 604-629-6100

bill@movehome.ca

www.movehome.ca

**1169 West 8th Avenue  
Vancouver, BC**

**TOTAL FINISHED AREA: 942 SQ.FT. \*\***

*OTHER AREA(S)*

DECK: 159 SQ.FT.\*

PATIO: 170 SQ.FT.\*

\*\* INCLUDES 26 SQ.FT. OF LOW CEILING HEIGHT AREA, BOUND BY DOTTED LINE.

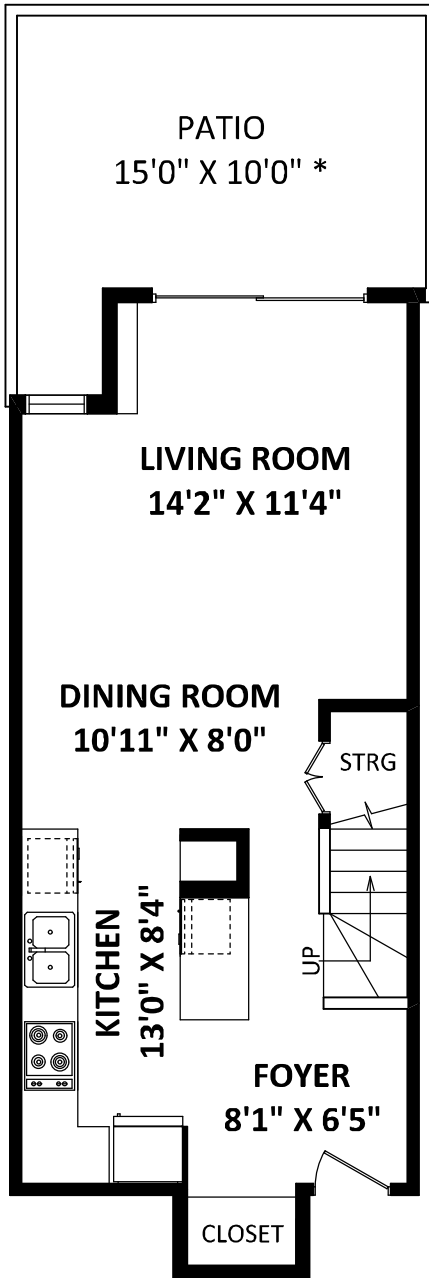

**MAIN FLOOR: 491 SQ.FT.**

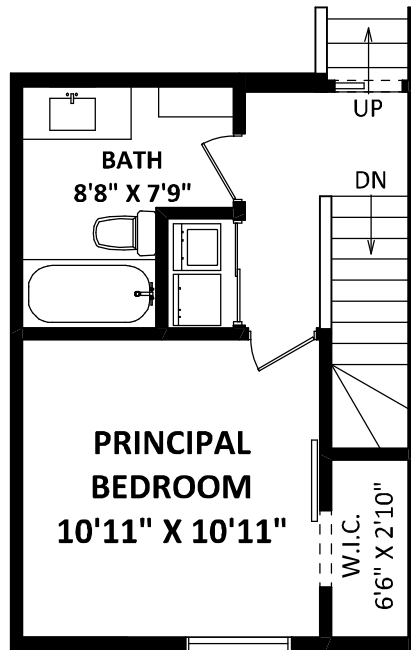

**UPPER FLOOR: 314 SQ.FT.**

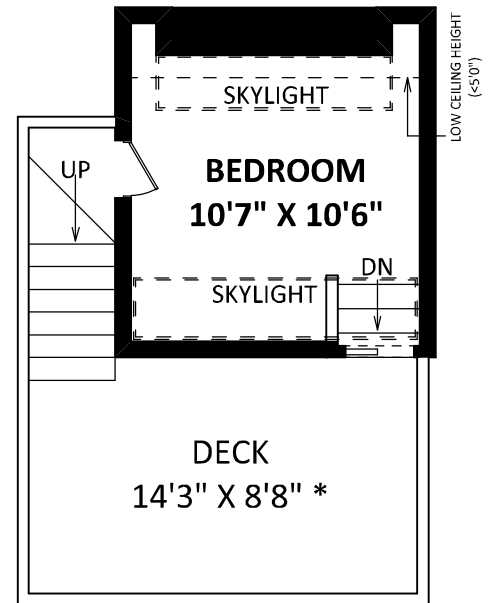

**TOP FLOOR: 137 SQ.FT.\*\***

\*\* INCLUDES 26 SQ.FT. OF LOW CEILING HEIGHT AREA, BOUND BY DOTTED LINE.

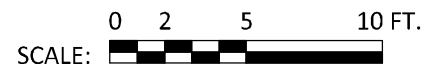

[JUNE 1, 2021]



TEL: 604-575-1244

www.seevirtual360.com

**DISCLAIMERS:**

1. MEASUREMENTS ARE FOR PROMOTIONAL USE ONLY & ARE NOT INTENDED FOR CONSTRUCTION USE. ROOM DIMENSIONS ARE APPROXIMATE. MEASUREMENTS & CALCULATIONS FOR FINISHED AREAS ARE E&O INSURED.
2. FINISHED AREAS ARE ENCLOSED AREAS IN A HOUSE THAT ARE SUITABLE FOR YEAR-ROUND USE, EMBODYING WALLS, FLOORS, AND CEILINGS THAT ARE SIMILAR TO THE REST OF THE HOUSE. (ANSI Z765-2013)
3. FOR STRATA LOTS, SQUARE FOOTAGE OF EACH LEVEL IS CALCULATED FROM THE CENTERLINE OF THE EXTERIOR WALLS OR SHARED WALLS OF THE STRATA LOT TO THE CENTERLINE OF THE EXTERIOR WALLS OR SHARED WALLS OF THE ADJACENT STRATA LOTS. (REF. STRATA PROPERTY ACT, SECTION 68)
4. THIS FLOOR PLAN MAY ONLY BE REPRODUCED WITH PERMISSION OF THE REALTOR(S) ON THIS FLOOR PLAN.
- \* ANY MEASUREMENTS WITH AN ASTERISK (\*) OR (APPROX) ARE APPROXIMATE AND FOR ILLUSTRATION PURPOSES ONLY AND ARE NOT E&O INSURED.