

#4 2435 Kelly Avenue,
Port Coquitlam, BC

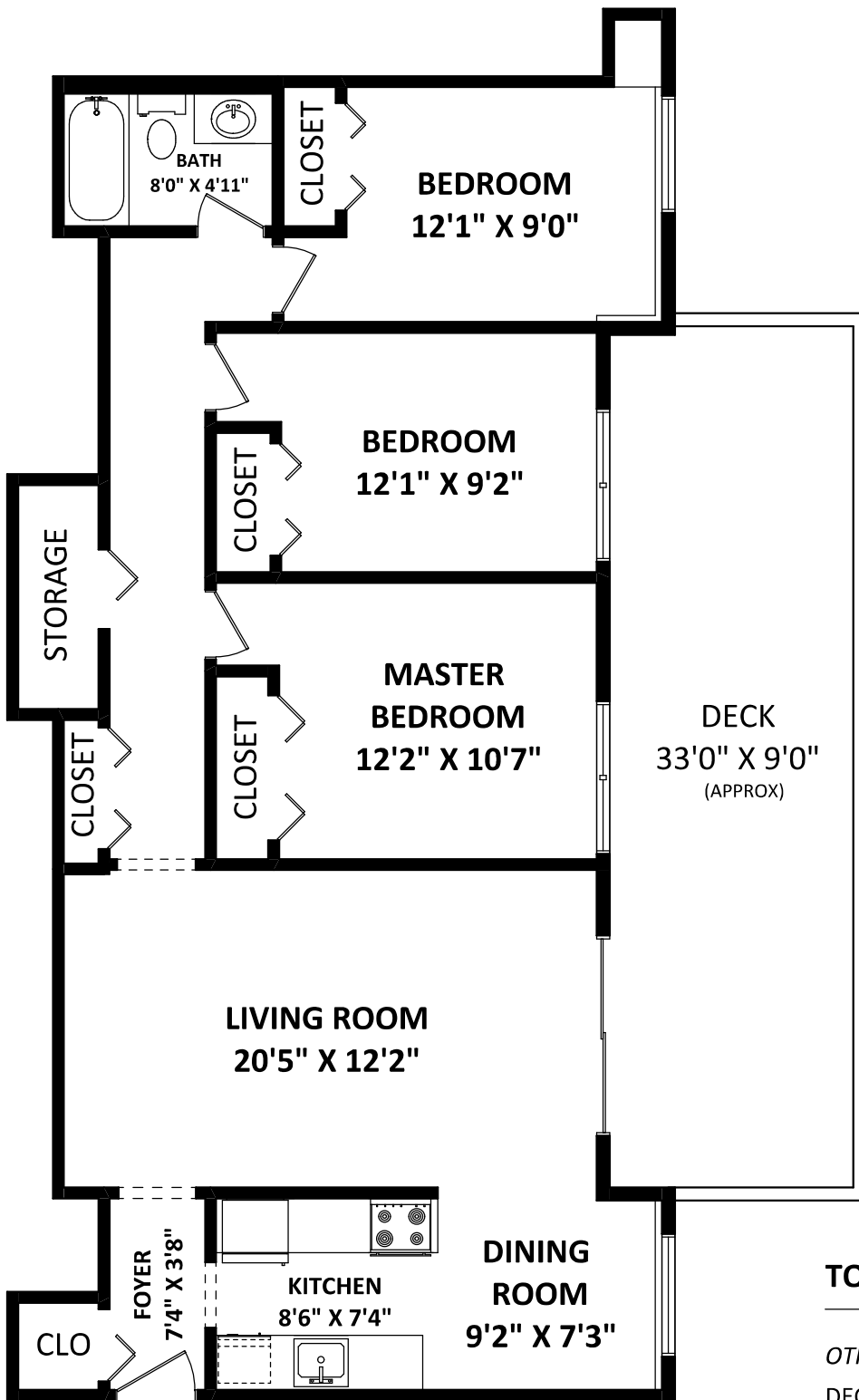

BOB CHARBONNEAU

RE/MAX Sabre Realty

Cell: 604-340-1747
Office: 604-942-0606
bob@askbob.ca
www.askbob.ca

TOTAL FINISHED AREA: 1118 SQ.FT.

OTHER AREA(S)

DECK: 319 SQ.FT.*

FLOOR PLAN BY:

[FEBRUARY 4, 2020]



TEL: 604-575-1244
www.seevirtual360.com

DISCLAIMER:

1. MEASUREMENTS ARE FOR PROMOTIONAL USE ONLY & ARE NOT INTENDED FOR CONSTRUCTION USE.
ROOM DIMENSIONS ARE APPROXIMATE. MEASUREMENTS & CALCULATIONS FOR FINISHED AREAS ARE E&O INSURED.
2. FINISHED AREAS ARE ENCLOSED AREAS IN A HOUSE THAT ARE SUITABLE FOR YEAR-ROUND USE,
EMBODIED WALLS, FLOORS, AND CEILINGS THAT ARE SIMILAR TO THE REST OF THE HOUSE. (ANSI Z765-2013)
3. THIS FLOOR PLAN MAY ONLY BE REPRODUCED WITH PERMISSION OF THE REALTOR(S) ON THIS FLOOR PLAN.
* ANY MEASUREMENT WITH AN ASTERISK (*) OR (APPROX) ARE APPROXIMATE AND FOR ILLUSTRATION PURPOSES
ONLY AND ARE NOT E&O INSURED.



NORTH

0 2 5 10 FT
SCALE: