

**#302 2035 W 4th Avenue,**  
Vancouver, BC



**MARY ELLEN MAASIK**

*Sutton Group West Coast - Kerrisdale*

Cell: 604-657-8865

Office: 604-267-3800

mmaasik@sutton.com

**TOTAL FINISHED AREA: 1069 SQ.FT.**

OTHER AREA(S)

TERRACE:

500 SQ.FT.\*

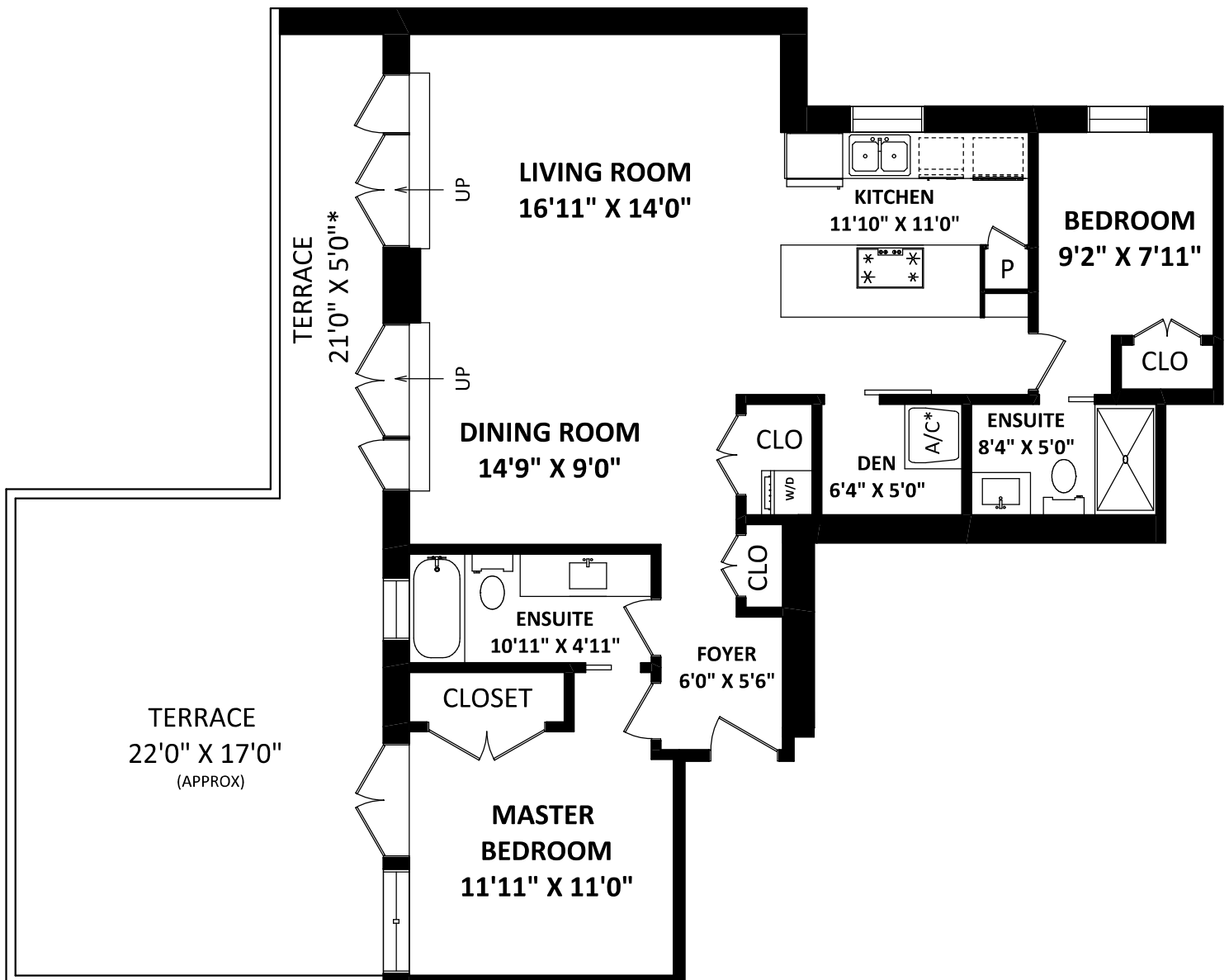

FLOOR PLAN BY:

[JULY 3, 2019]



TEL: 604-575-1244

www.seevirtual360.com

DISCLAIMER:

1. MEASUREMENTS ARE FOR PROMOTIONAL USE ONLY & ARE NOT INTENDED FOR CONSTRUCTION USE.  
ROOM DIMENSIONS ARE APPROXIMATE. MEASUREMENTS & CALCULATIONS FOR FINISHED AREAS ARE E&O INSURED.  
2. FINISHED AREAS ARE ENCLOSED AREAS IN A HOUSE THAT ARE SUITABLE FOR YEAR-ROUND USE,  
EMBODIED WALLS, FLOORS, AND CEILINGS THAT ARE SIMILAR TO THE REST OF THE HOUSE. (ANSI Z765-2013)  
3. THIS FLOOR PLAN MAY ONLY BE REPRODUCED WITH PERMISSION OF THE REALTOR(S) ON THIS FLOOR PLAN.  
\* ANY MEASUREMENT WITH AN ASTERISK (\*) OR (APPROX) ARE APPROXIMATE AND FOR ILLUSTRATION PURPOSES  
ONLY AND ARE NOT E&O INSURED.



SCALE: 0 2 5 10 FT