

#22 1141 Eagleridge Drive,
Coquitlam, BC



BOB CHARBONNEAU

RE/MAX Sabre Realty

Cell: 604-340-1747
Office: 604-942-0606
bob@askbob.ca
www.askbob.ca

TOTAL FINISHED AREA: 1310 SQ.FT.

OTHER AREA(S)

CARPORT: 182 SQ.FT.
PATIO: 134 SQ.FT.*
SHED: 64 SQ.FT.*

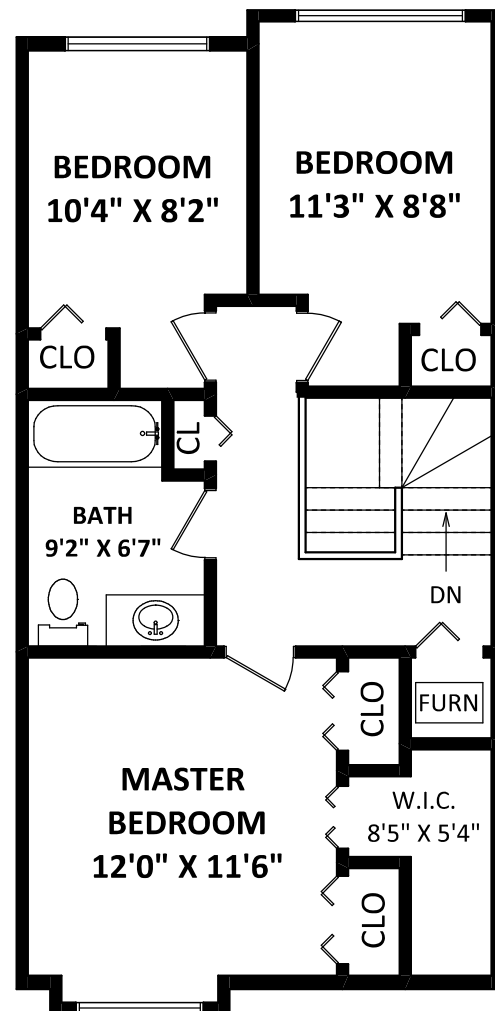
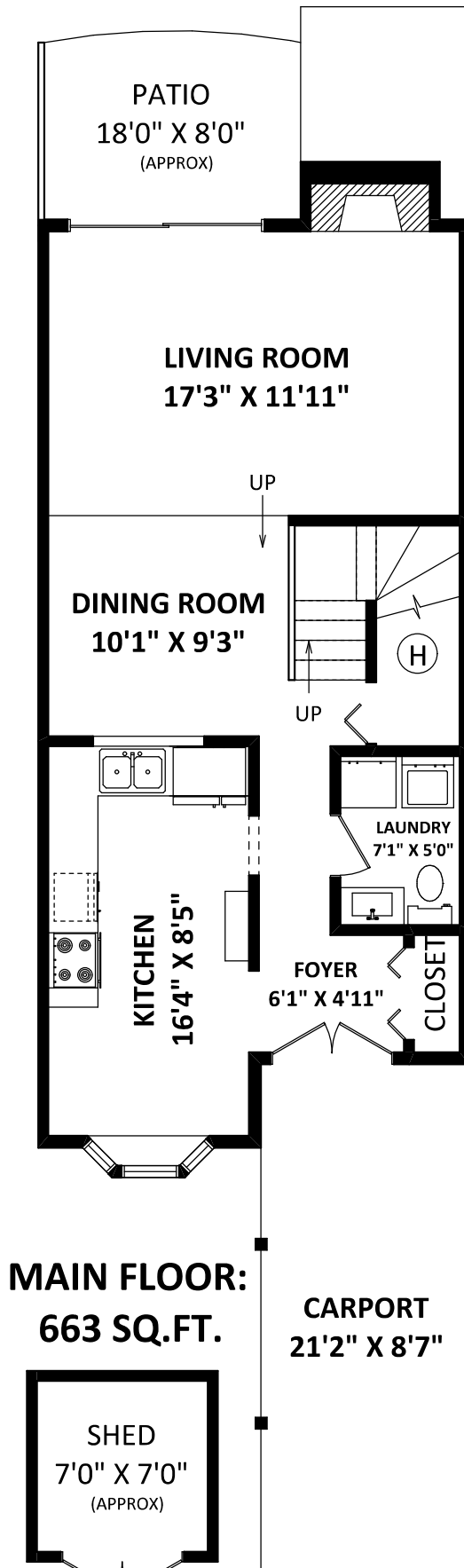

DISCLAIMER:

1. MEASUREMENTS ARE FOR PROMOTIONAL USE ONLY & ARE NOT INTENDED FOR CONSTRUCTION USE.
ROOM DIMENSIONS ARE APPROXIMATE. MEASUREMENTS & CALCULATIONS FOR FINISHED AREAS ARE E&O INSURED.
2. FINISHED AREAS ARE ENCLOSED AREAS IN A HOUSE THAT ARE SUITABLE FOR YEAR-ROUND USE,
EMBODIFYING WALLS, FLOORS, AND CEILINGS THAT ARE SIMILAR TO THE REST OF THE HOUSE. (ANSI Z765-2003)
3. THIS FLOOR PLAN MAY ONLY BE REPRODUCED WITH PERMISSION OF THE REALTOR(S) ON THIS FLOOR PLAN.
* ANY MEASUREMENT WITH AN ASTERISK (*) OR (APPROX) ARE APPROXIMATE AND FOR ILLUSTRATION PURPOSES
ONLY AND ARE NOT E&O INSURED.

FLOOR PLAN BY:

[OCTOBER 10, 2017]



TEL: 604-575-1244
www.seevirtual360.com

SCALE: 0 2 5 10 FT

