

**#5 2243 Bellevue Avenue,**  
**West Vancouver, BC**



**KIM TAYLOR**

*Royal LePage Sussex*

Cell: 604-315-2645

Office: 604-925-2911

kim@kimtaylorhomes.com

www.kimtaylorhomes.com

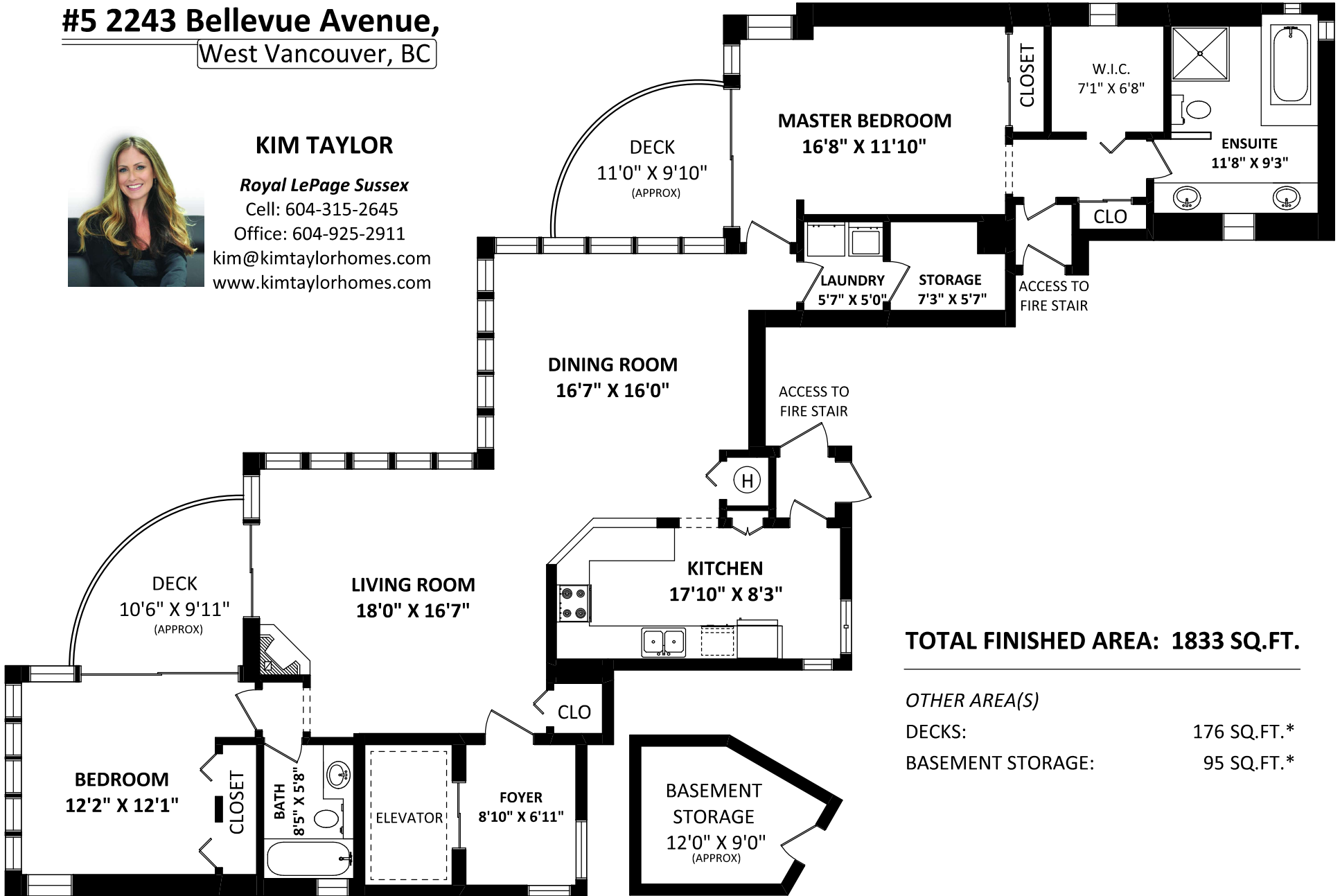

**TOTAL FINISHED AREA: 1833 SQ.FT.**

*OTHER AREA(S)*

DECKS: 176 SQ.FT.\*

BASEMENT STORAGE: 95 SQ.FT.\*

FLOOR PLAN BY:

[AUGUST 3, 2017]



TEL: 604-575-1244

www.seevirtual360.com

**DISCLAIMER:**

1. MEASUREMENTS ARE FOR PROMOTIONAL USE ONLY & ARE NOT INTENDED FOR CONSTRUCTION USE. ROOM DIMENSIONS ARE APPROXIMATE. MEASUREMENTS & CALCULATIONS FOR FINISHED AREAS ARE E&O INSURED.
2. FINISHED AREAS ARE ENCLOSED AREAS IN A HOUSE THAT ARE SUITABLE FOR YEAR-ROUND USE, EMBODYING WALLS, FLOORS, AND CEILINGS THAT ARE SIMILAR TO THE REST OF THE HOUSE. (ANSI Z765-2003)
3. THIS FLOOR PLAN MAY ONLY BE REPRODUCED WITH PERMISSION OF THE REALTOR(S) ON THIS FLOOR PLAN.
- \* ANY MEASUREMENT WITH AN ASTERISK (\*) OR (APPROX) ARE APPROXIMATE AND FOR ILLUSTRATION PURPOSES ONLY AND ARE NOT E&O INSURED.

