

Welcome To

350 East Keith Road, North Vancouver



TOTAL FINISHED AREA: 2141 SQ.FT

OTHER AREA(S)

GARAGE: 461 SQ.FT.
 PATIO(S): 292 SQ.FT.*
 DECK(S): 274 SQ.FT.*

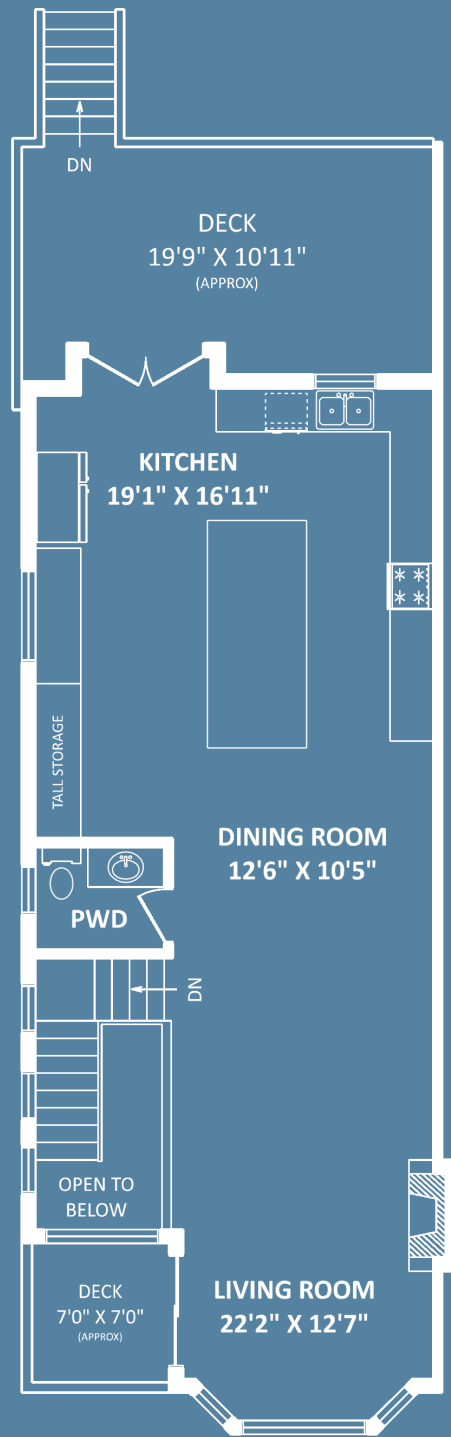

MAIN FLOOR: 963 SQ.FT.

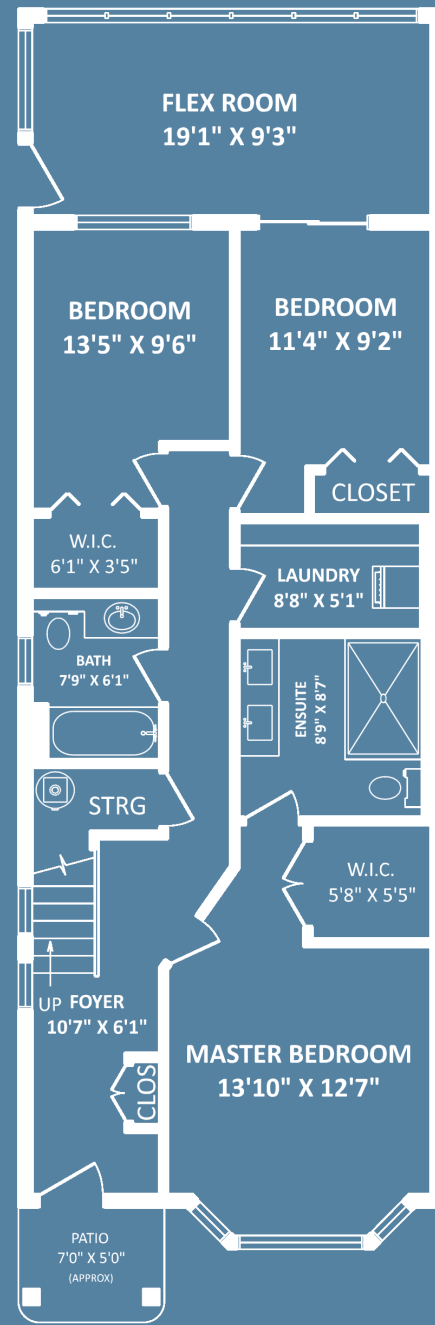

LOWER FLOOR: 1178 SQ.FT.

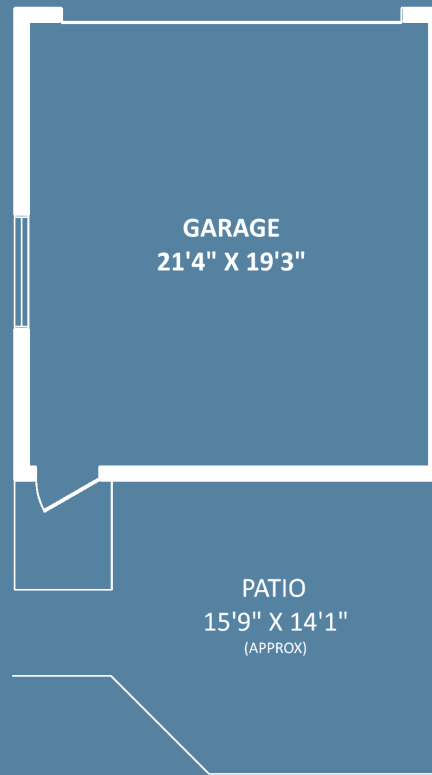

This version of the floorplan is for marketing purposes only. Please contact Judy Anderson for specifications

This communication is not intended to cause or induce breach of an existing agency agreement



Judy Anderson

(604) 315-4066
 judyanderson@shaw.ca
 www.judyanderson.com

RE/MAX CREST REALTY

101 - 2609 WESTVIEW DRIVE NORTH VANCOUVER, BC V7N 4M2





350 East Keith Road, North Vancouver

Panoramic city and harbour views from this beautifully renovated 3 bdrm, 1/2 duplex with high end finishes thru-out. Open concept flr plan on main with massive kitchen and center island topped with quartz meteorite stone. More than enough Hertco soft close custom cabinetry to make any cook happy. Radiant in flr heating, AC, wide plank oak flooring on both floors, Control 4 communication system, Brigade gas range, kohler fixtures and air jacuzzi bathtub. Master bedroom features a large walk-in shower, double sinks, walk-in closet and california shutters. The list goes on; roller blinds, retractable awning, murphy bed, in ground irrigation, deck off the kitchen and back yard with sunny patio for more entertaining. Truly a move in and enjoy home with lrg double garage off paved lane.

Year Built	2001
Style	2 Storey
Bedrooms	3
Bathrooms	3
Size	2,141 ft ²
Lot	3,925 ft ²
Type	½ Duplex

For more photos and a virtual tour, please visit: www.judyanderson.com



RE/MAX CREST REALTY
 101 - 2609 WESTVIEW DRIVE
 NORTH VANCOUVER BC V7N 4M2