

205 - 15195 36<sup>th</sup> Avenue, Surrey

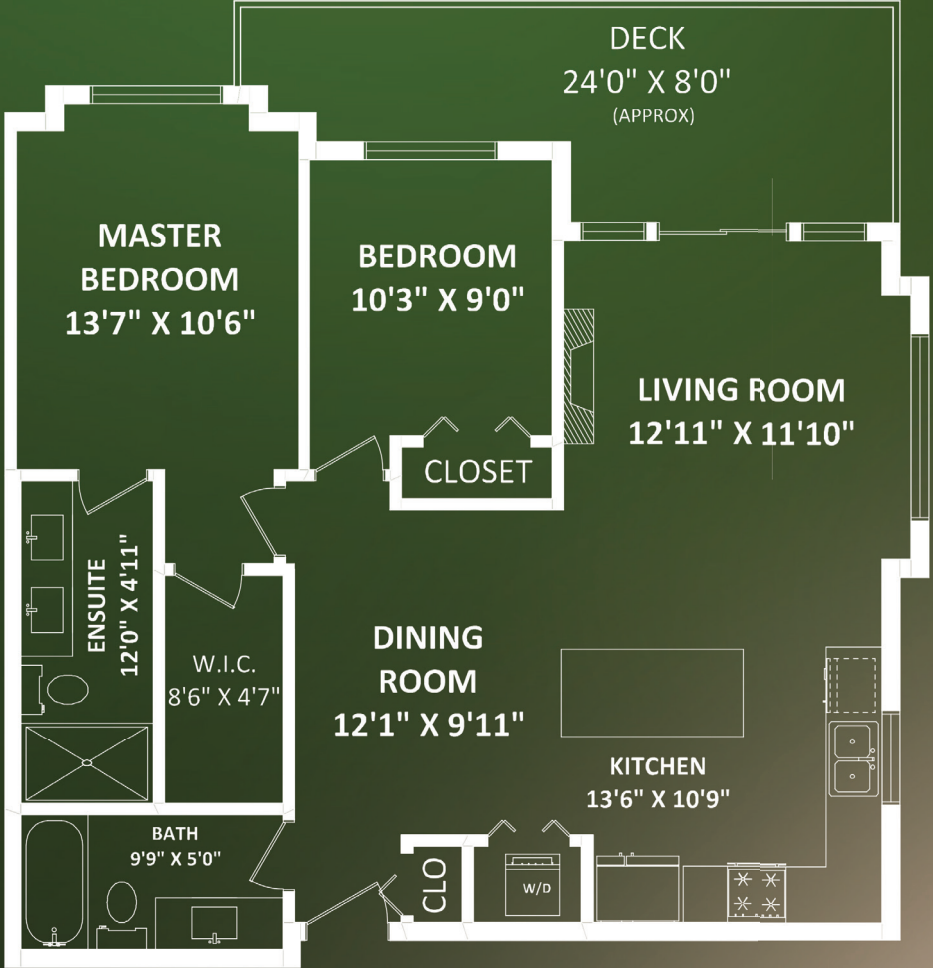

TOTAL FINISHED AREA: 960 SQ.FT.

OTHER AREA(S)  
DECK: 160 SQ.FT.\*

Features

Bedrooms:	2
Bathrooms:	2
Style of Home:	Corner Unit
Year Built:	2012
Taxes:	\$415.00
Maintenance Fee:	\$2,441.29



THINKING OF SELLING YOUR HOME? CALL TODAY.

LICENSED SINCE 1990  RESPECTED FOR RESULTS

Terry Plottel

terryplottel.com  
604.889.0265



An independent member broker.

This version of the floorplan is for marketing purposes only.  
Please contact Terry Plottel for specifications: 604-889-0265  
This communication is not intended to cause or induce breach of an existing agency agreement.







## 205 - 15195 36<sup>th</sup> Avenue, Surrey

Welcome to the Edgewater. Resort Style Living in a convenient, secure gated community. Rarely available 2 bedroom 2 bathroom corner residence! Enjoy all the natural light in the winter and rainy days with the extra wall of windows. Drop the gym membership enjoy the many amenities this complex has to offer, large gym, yoga studio, outdoor pool, lounging area, and walking trails. Out of town guest suites available, storage locker, 2 side by side parking in secure underground garage. Make a lifestyle Change, book your appointment through your Realtor Today.



Terry Plottel 604-889-0265  
Sutton Group West Coast Realty  
#102 403 North Rd  
Coquitlam BC V3K 3V9

For more photos and a virtual tour, please visit: [www.terryplottel.com](http://www.terryplottel.com)