

Welcome To

801 1600 Howe Street, Vancouver

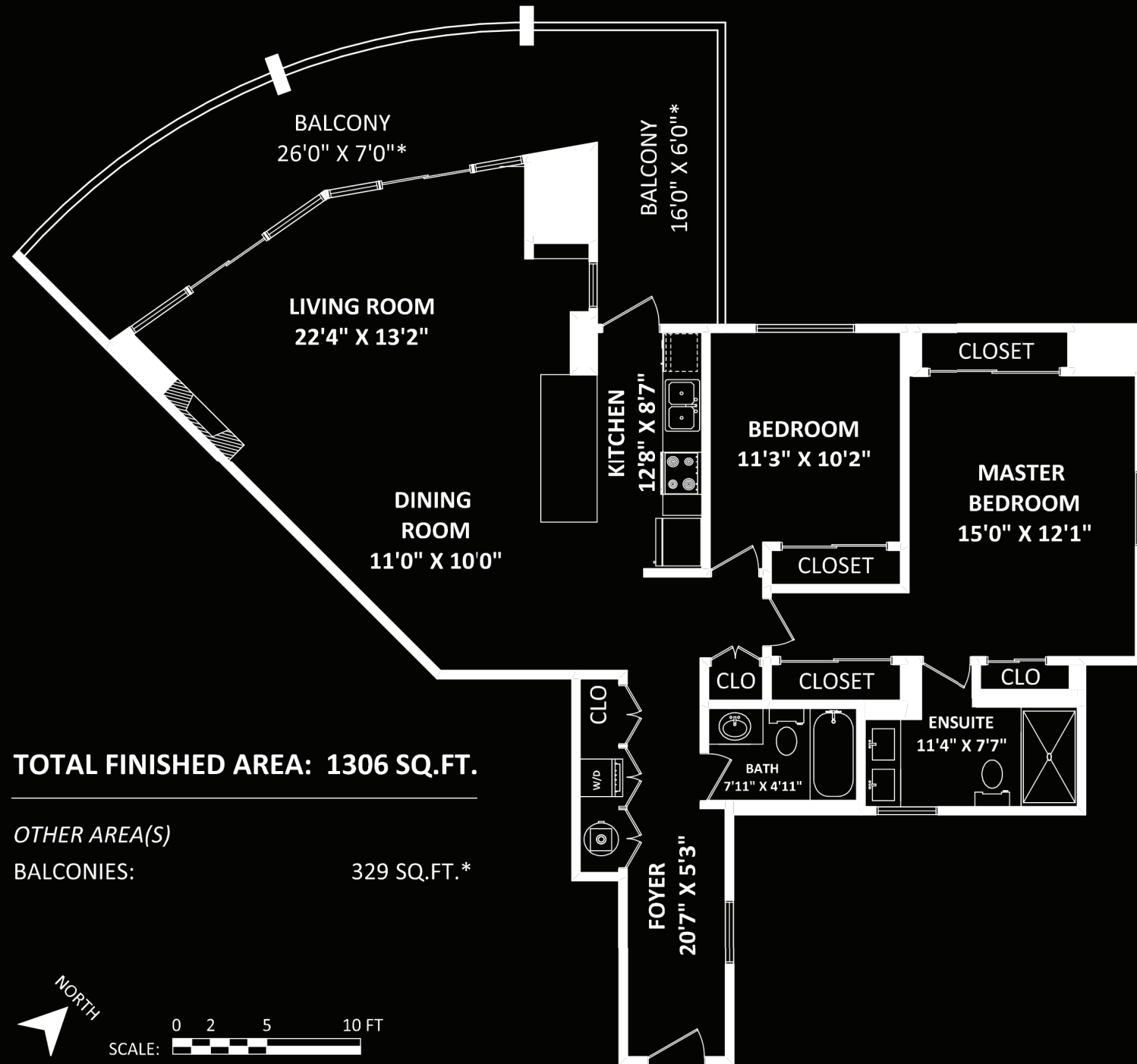

TOTAL FINISHED AREA: 1306 SQ.FT.

OTHER AREA(S)
BALCONIES: 329 SQ.FT.*



Robyn Lau

Personal Real Estate Corporation

Engel & Völkers Vancouver
604-306-3915

www.robynlau.com



This version of the floorplan is for marketing purposes only.
Please contact Robyn Lau PREC for specifications: 604-306-3915

This communication is not intended to cause or induce breach of an existing agency agreement.





801 1600 Howe Street, Vancouver

Waterfront views to take the cares of your day away. This 2 bedroom condo at over 1300 sf is a rare find in Vancouver. Renovated and ready for you to move in to call this great place home. One block from the new Vancouver House this condo offers the peace and serenity that the larger complex's cant as it sits directly on the boardwalk. Bright, large open floor plan plus large SW facing 329sf wrap around view deck. Add to that, LOCATION LOCATION -its close to shopping, restaurants, minutes from the beach as well as Yaletown. The Granville Island ferry is just steps from your front door. 24hr Concierge, gym, storage & 2 parking (one is completely enclosed.) Need I say more? Come on out and see this fantastic condo.

Strata Fees	\$749.00
Year Built	1987
Style	Corner Unit
Type	Attached
Bedrooms	2
Bathrooms	2
Size	1,306 ft ²
Taxes	\$4,597.72

For more photos and a virtual tour, please visit: www.robynlau.com

 Robyn Lau PREC 604-306-3915
 Engel & Völkers Vancouver
 130 - 1152 Mainland Street
 Vancouver, BC V6B 4X2