

10036 157A Street,  
Surrey, BC

Welcome to

10036 - 157A Street, Surrey



TOTAL FINISHED AREA: 2011 SQ.FT.

OTHER AREA(S)

UNFIN. BASEMENT: 693 SQ.FT.  
GARAGE: 507 SQ.FT.  
PATIO: 310 SQ.FT.\*

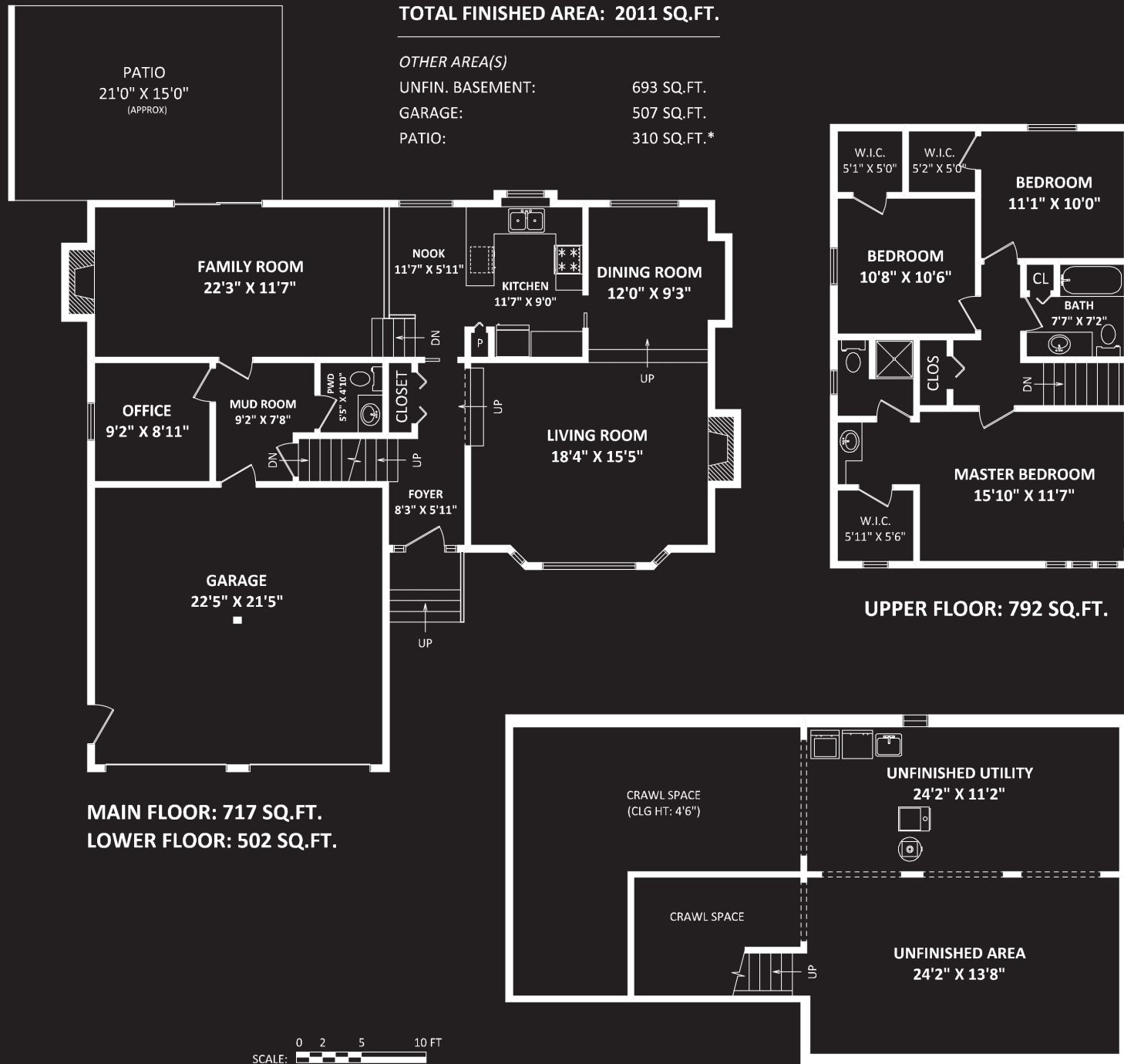

**Brittany Vu**

Phone: (604) 710-9581  
Email: brittany@royallepage.ca  
Website: brittanyvu.com

ROYAL LEPAGE WEST R.E.S.  
#6 9965 152 St, Surrey, BC V3R 4G5



This version of the floorplan is for marketing purposes only.  
Please contact Brittany Vu for specifications: (604) 710-9581

This communication is not intended to cause or induce breach of an existing agency agreement.







10036 - 157A Street, Surrey

DESIRABLE SUMERSET NEIGHBORHOOD IN THE HEART OF GUILDFORD! Enjoy quiet, relaxing surroundings yet close to all amenities. This home features a welcoming foyer & bright living area cheerfully welcomes any visitor. Company coming? Dine in style in this formal Dining room. Recipe for success: Efficient style plus warmth in the kitchen. Master bdrm is enhanced by in-suite and a walk in closet. Secluded patio surrounded by rolling lawn, flowering shrubs, and trees provides peaceful relaxation. DEMAND LOCATION: convenient to bus, schools, T&T, Guildford Mall, Library Rec. Center & the newer Guildford Swimming pool. GOOD TIMING MAKES GOOD SENSE. Call for your personal tour!



Style	4 Level Split
Year Built	1983
Lot	7,104 ft <sup>2</sup>
Bedrooms	3 + Den
Bathrooms	2 Full   1 Half
Size	2,704 ft <sup>2</sup>
Unfinished Sqft	693 ft <sup>2</sup>

For more photos and a virtual tour, please visit: [brittanyvu.com](http://brittanyvu.com)



BRITTANY VU  
 Phone: (604) 710-9581  
 Email: [brittany@royallepage.ca](mailto:brittany@royallepage.ca)  
 Website: [brittanyvu.com](http://brittanyvu.com)

ROYAL LEPAGE WEST R.E.S.  
 #6 9965 152 St, Surrey, BC V3R 4G5