

313 Princeton Avenue, Port Moody



313 Princeton Avenue, Port Moody



This Tudor-style Family Home in the popular College Park area of Pt Moody sits on a corner lot, close to transit, shopping & parks. Over 4,600 sq ft of living space! It features 5 bedrooms up + a flexible room that could easily be an office or den, 4 baths, a full basement, 3 fireplaces & a very useful mud room with a door to the back yard. Enjoy the back patio/yard with access from both the eating area & the dining room. The double garage offers lots of storage + has an existing workbench/shop area for the handyman. View of the Inlet from upstairs & the mature, manicured landscaping gives a welcoming street appeal.

Dianne Swintak

Mick McLennan

604-421-1010 • 778-836-3300

604-240-2202 • 604-526-2888

dswintak@gmail.com

contactus@uniserve.com

www.burnabycoquitlamhomes.com

www.realestatenewwest.com

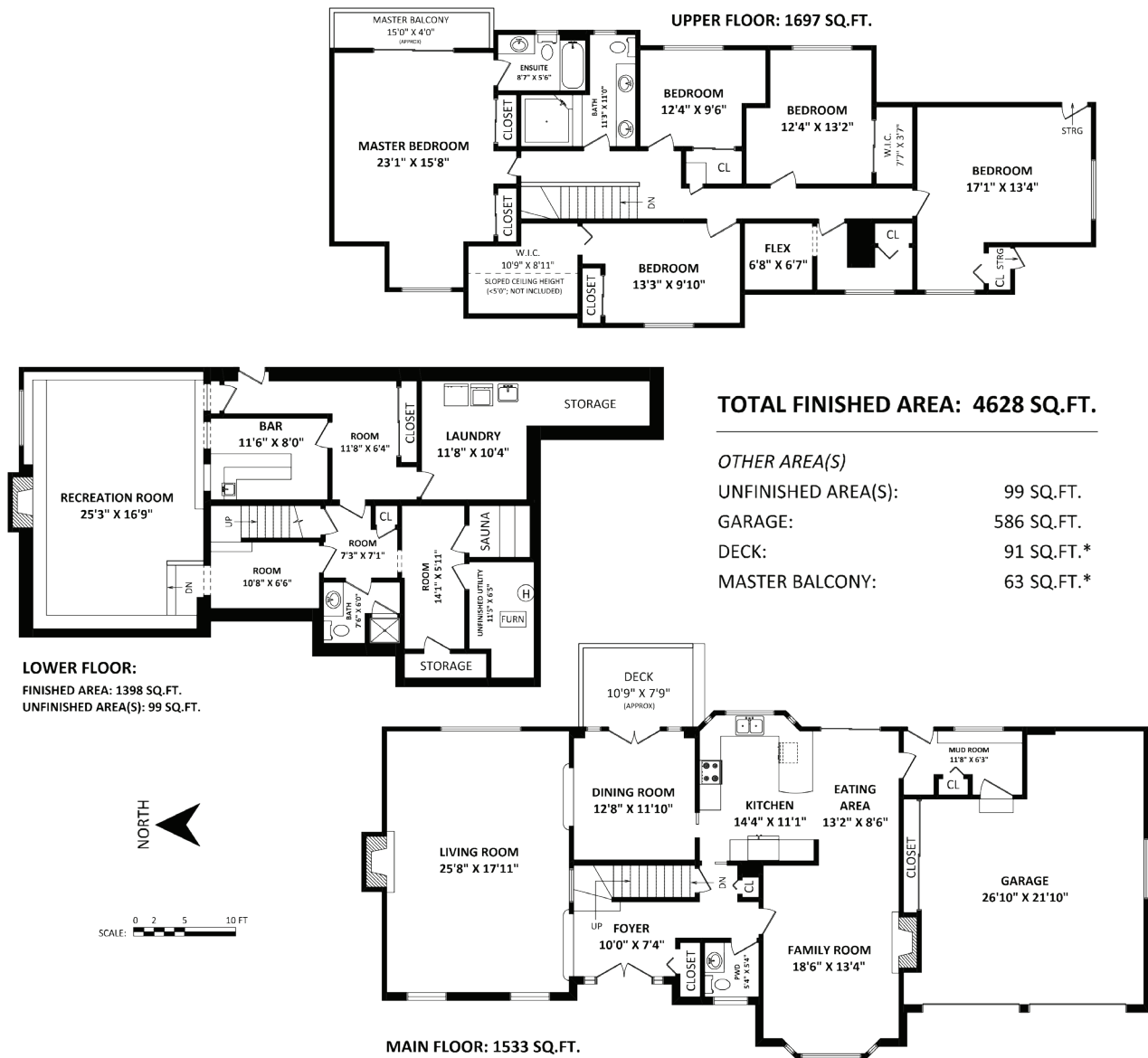

Features

Bedrooms:	5 + Den	Fireplaces:	3
Bathrooms:	4	Parking:	Double Garage
Lot:	7694 sq ft	Taxes:	\$5,626.86 - 2017
Style of Home:	Tudor	Year Built:	1976
Size:	1533 main - 1697 above - 1398 down = 4,628		



RE/MAX ADVANTAGE REALTY

Mick McLennan

604-526-2888 • 604-240-2202



ROYAL LEPAGE STERLING REALTY

Dianne Swintak

604-421-1010 • 778-836-3300





RE/MAX ADVANTAGE REALTY
102 - 321 6th St, New Westminster, BC V3L 3A7

Mick McLennan • 604-240-2202 • 604-526-2888
contactus@uniserve.com • www.realestatenewwest.com



ROYAL LEPAGE STERLING REALTY
3137 St. Johns St Port Moody, BC V3H 2C8

Dianne Swintak • 604-421-1010 • 778-836-3300
dswintak@gmail.com • www.burnabycoquitlamhomes.com