

6675 264 STREET
ALDERGROVE

ANDY SCHILDHORN
778-835-8951

TOTAL USABLE AREA
1634 SQUARE FEET

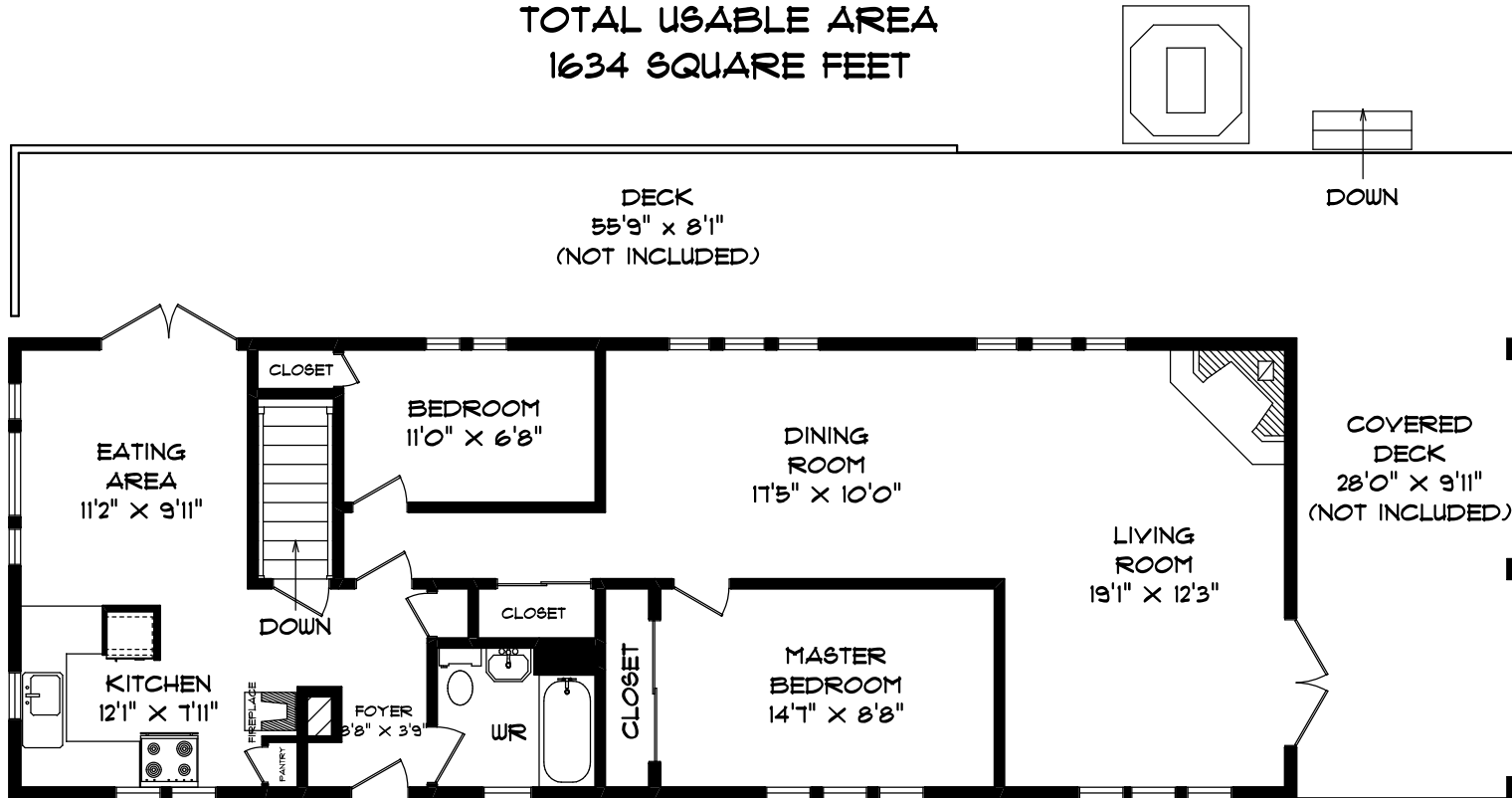

MAIN LEVEL
1128 SQUARE FEET

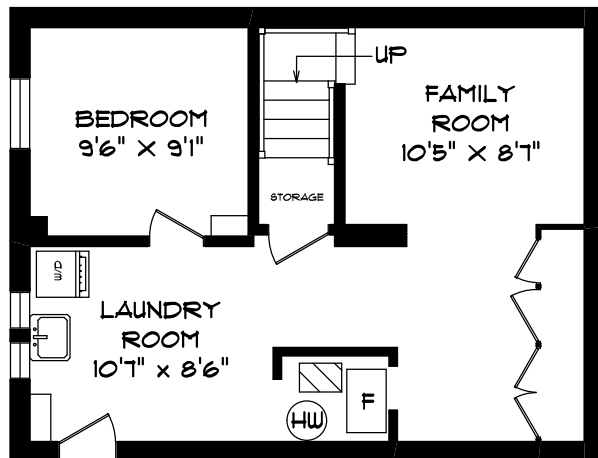

LOWER LEVEL
506 SQUARE FEET

Seevirtual360.com

- FLOOR PLANS - - - - - MAY 08 -
ROOM SIZES SHOULD BE CONSIDERED APPROXIMATE.
MEASUREMENTS ARE FOR PROMOTIONAL USE ONLY
AND ARE SUBJECT TO CERTIFICATION. E & O. E.

604.575.1244