

#3603 9981 Whalley Blvd Rd, Surrey

# Top Floor - Park Place 2

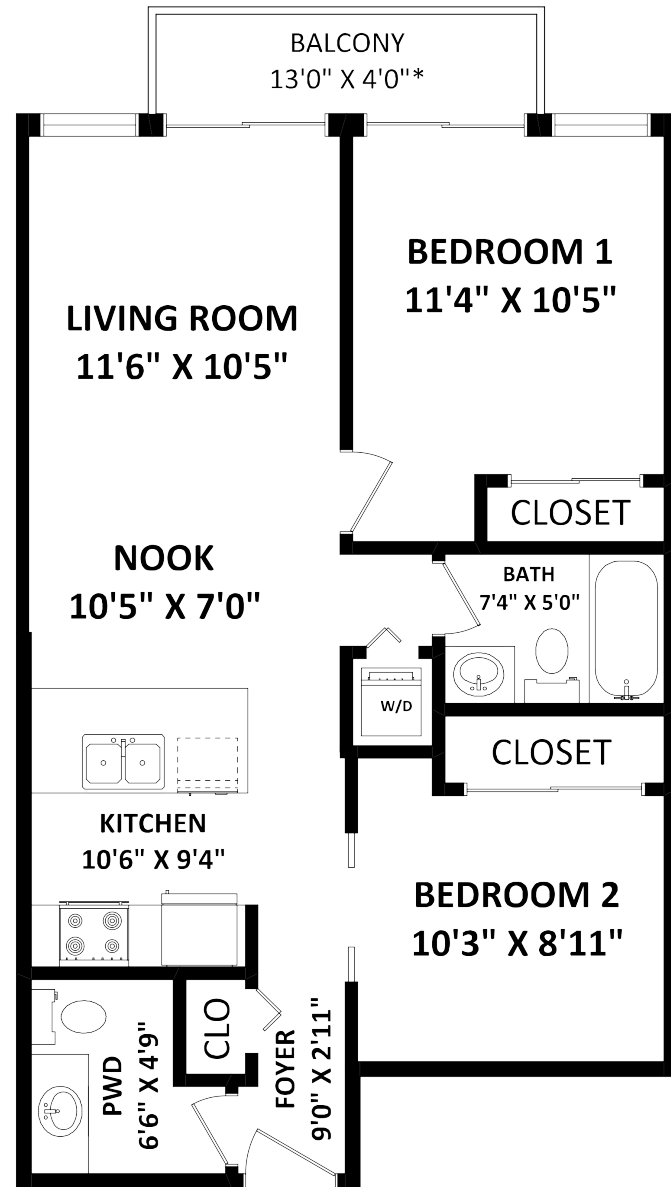

TOTAL FINISHED AREA: 744 SQ.FT.

OTHER AREA(S)  
DECK: 45 SQ.FT.\*



#3603 9981 Whalley Blvd Rd  
Surrey



Karn Kalkat  
604-600-7052



Sandeep Kalkat  
604-780-7085

Please contact Karn Kalkat, HomeLife Benchmark Titus Realty and Sandeep Kalkat, Coldwell Banker Vantage Realty  
604-600-7052 • [karnkalkat@live.ca](mailto:karnkalkat@live.ca) for specifications.

This communication is not intended to cause or induce breach of an existing agency agreement.



HomeLife Benchmark Titus Realty  
#101 15385 No. 10 Hwy Surrey, BC V3S 0X9  
[www.homelifetitus.com/karnkalkat](http://www.homelifetitus.com/karnkalkat)

Coldwell Banker Vantage Realty  
#200 15135 101 Ave Surrey, BC V3R 7Z1





*Listing Information*

*Rare 'Park Place II' 2 bedroom and 2 Bathroom Penthouse suite available for sale in Central City Surrey. This 36th floor, east facing unit boasts breathtaking views of Mount Baker and city parks. This rarely used condo has been updated to include stainless steel appliances, new laminate flooring and fresh paint throughout. Park Place offers some of the best amenities strata can provide including Club House equipped with fully functioning kitchens and BBQ areas, Theater room, Billiards room, a Bowling Alley, as well as a state of the art fitness facility. Don't miss out.*

Type:	Condo	Size:	769 ft <sup>2</sup>
Style of Home:	Penthouse	Bedrooms:	2
Year Built:	2011	Bathrooms:	Full: 1 Half: 1

Kam Kalkat • 604-600-7052 • HomeLife Benchmark Titus Realty  
 Sandeep Kalkat • 604-780-7085 • Coldwell Banker Vantage Realty

Kam Kalkat • 604-600-7052 • HomeLife Benchmark Titus Realty  
 Sandeep Kalkat • 604-780-7085 • Coldwell Banker Vantage Realty